

WDJ13 Conductive Plastic Potentiometer

WDJ13 導電塑膠旋轉位移精密電位器



FEATURES

特性

High reliability	高可靠性
Low cost	經濟
Long life	長壽命
Metal shaft	金屬軸柄
Precision manufacturing technique	精密製造技術
Max to 1,000,000 turns	可達 1000 萬次迴旋

MAIN SPECIFICATION

主要参数

Range of value (標稱阻值範圍):	500~5M ohm
Tolerance (阻值偏差):	±5% , ±10% , ±20%
Max voltage (最高工作電壓):	250V(linear)
Dielectric strength(絕緣強度):	750(V)
Power rating(額定功耗):	1W (70)
Operating temperature (環境溫度):	- 25 +70
Storage temperature (儲存溫度):	-40~+85
Taper (阻值規律):	Linear, Log, Alog
Temperature coefficient (溫度係數):	< 500ppm/
Wiper torque (旋轉力矩):	4 45Ncm
Angle of Electronic (有效電氣角度):	300°±5°
(other upon request 其他角度可依要求)	
Electrical Life(機械耐久性):	±10%
Rotational Life (迴旋壽命):	200K, 500K,1M Cycles
Bear to weld (耐焊接熱):	350 ±10 /5 sec
Vibration (耐振動):	±2%

HOW TO ORDER e.g. (如何訂購示例):

WDJ13105A1010EY300Z340F20

WDJ13	105	A	1010	E	Y300	Z340	F20
Series	Value	Taper	Tolerance	Life(turns)	Elec-Angle	Rotation Angle	Shaft
WDJ13	501=500ohm	A=Lin	2020=±20%	S:Standard	Y40	Z300	F20
	222=2.2Kohm	B=Log	1010=±10%	200000(S)	Y90	Z340	F22.3
	104=100Kohm	C=Alog	0505=+5%~-5%	Long life	Y180	Z360(no-Stop)	F30
	105=1Mohm		eg	500000(L)	Y270	eg	R22.3
	505=5Mohm		(See note 2)	1000000(E)	Y300		S22.3
	(See note 1)			2000000(2E)	Y355 eg		eg

Note:

(1)Value: Code 10 2 = 1000 ohm

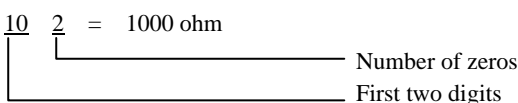

(2)Tolerance(non standard):Upon request: Code e.g. +5 = 05 05

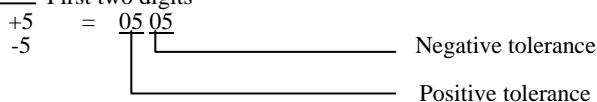

Technical datas

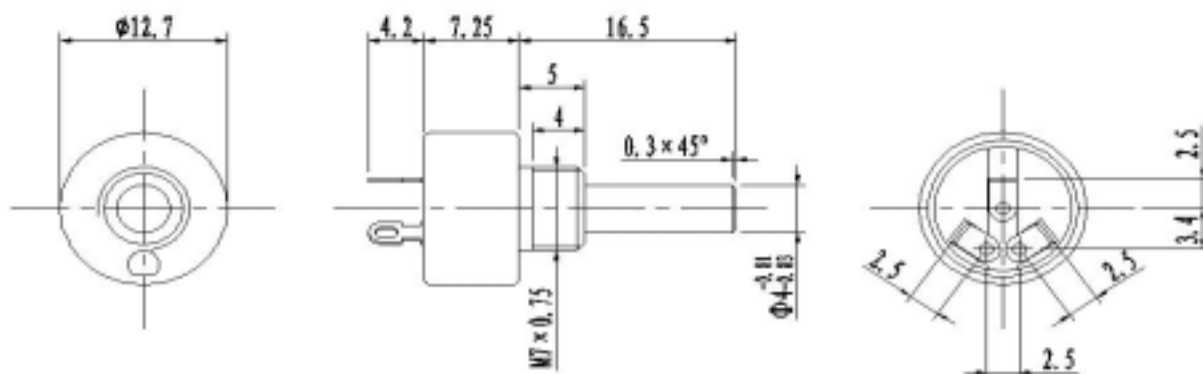

Note: Shaft shape and length upon requirement.

PACKAGING 包裝

MODEL	PCS/UNITS
A small Box (one unit)	20
Bulk(50 units)	1000

LIKE PRODUCT 本工廠生產的同類產品



OF22 22mm Conductive Plastic Potentiometer



OF40 42.5mm Conductive Plastic Potentiometer



WDJ16 16mm Conductive Plastic Potentiometer



WDJ22 22mm Conductive Plastic Potentiometer



RVQ24 24mm Conductive Plastic Potentiometer



RV26 26mm Resin type Longlife Potentiometer